

YOUR WISH IS OUR COMMAND

Technical lights

CATALOGUE



Mobile work light

Pages 4-18

FlashLED
Battery light



Page 4

WorkLED
Battery-hand lamp



Page 5

STILO / MINI
Torch light



Page 6

MIDI / MAXI
Torch light



Page 6

SECURITY
Torch light



Page 7

FOREHEAD
Head lamp



Page 8

Outdoor and industry light

Pages 21-29

GT 70
Safety tubular light



Page 21

GT 70
Safety tubular light short



Page 22

StreamLIGHT
Safety tubular light



Page 23

StreamLED
Safety tubular light



Page 24

Accessories
Safety tubular light



Page 25

Wet fittings



Page 26

LED Spotlight halogen spotlight

Pages 30-33

SpotLED
LED-Spotlight



Page 30

Halogen Spotlight
230VAC



Page 31

Halogen Spotlight
24VDC/42VDC



Page 31

Accessories
Halogen Spotlight



Page 32

SYLVEO
Spotlight



Page 33

Lamps

Page 34

Lamps



Page 34

Further light program

Pages 38-39

MarkLED



Page 38

FlatLED



Page 38

SecuLED



Page 38

VisuLED



Page 39

CircLED



Page 39

ToppLED



Page 39

MITRALUX L140
Hand-held lamp



Page 9

MULTI
Working lamp



Page 9

ApolloLIGHT
Wide area lighting sys.



Page 10

PRIMA
Flood light



Page 12-13

MULTI
Working lamp



Page 14-15

FL / PLC
Tubular lamp



Page 16

DULUX
Tubular lamp



Page 17

Halogen-
Hand-held Spotlight



Page 18

META
Workplace light



Page 28

FLÄCHE
Workplace light



Page 29

PUNKT
Workplace light



Page 29

FlashLED work and inspection lamp with emergency light function

The latest charging and monitoring electronics combined with a modern design and state-of-the-art LED technology are the basis of that new and innovative handlamp!

Product Features

- powerful handlamp with 5x3W Power-LED (1'000 lumen)
- long lifetime of LED's (up to 50'000 hours)
- up to 7 hours battery lifetime
- impact proof sturdy polyamide housing
- emergency light function in case of power failure
- 3 light modes: broad beam, work light, wide beam; continuously dimmable
- Memory function = last setting is saved
- NiMH accumulator for high energy density
- corrosion-resistant charging contacts (spring steel)
- over-current, temperature and deep discharge protection
- vertical swivelling light head
- Made in Switzerland

Technical data

Power supply: 230VAC/24VDC/12VDC
 Electric power supply: Battery pack NiMH 7.2V - 4'500mAh
 Charging time: 10h
 Luminous period:

Broad beam 3xLED 8° = 9h
 Work light 5xLED 8°/26° = 4h
 Wide beam 2xLED 45° = 7h

Lamps:

Light output Broad beam: 804lm
 Light output Work light: 963lm
 Light output Side light: 261lm
 IP rating lamp: IP65
 IP rating charging station: IP54

Protection class

Lamp: II
 charging station: II

Dimensions (HxWxD)

- Lamp incl. charging station: 332x149x106mm
- Lamp excl. charging station: 260x125x92.5mm
- Charging station: 276x149x95mm

Weight

- Lamp: 1'400g
- Charging station: 700g



Item	Designation
034604	FlashLED work and inspection lamp with emergency light function without charging station
034605	FlashLED charging station 230VAC, IP54, incl. 1.5m cable and plug Euro
034606	FlashLED charging station 12-24VDC, with plug-in connection, without cable
040694	Car connection cable for charging station 12-24VDC, 2m cable, with plug 2P ø2.1mm
014019	Charging cable for permanent installation 2m cable, with plug
Accessories / spare parts	
034607	Accumulator NiMH 7.2V/4'500mAh for FlashLED
081486	Accumulator NiMH 7.2V/4'500mAh for FlashLED mounting by GIFAS incl.
035013	Shoulder strap for FlashLED
034638	Coloured filter set for FlashLED and SpotLED (red, green, yellow)

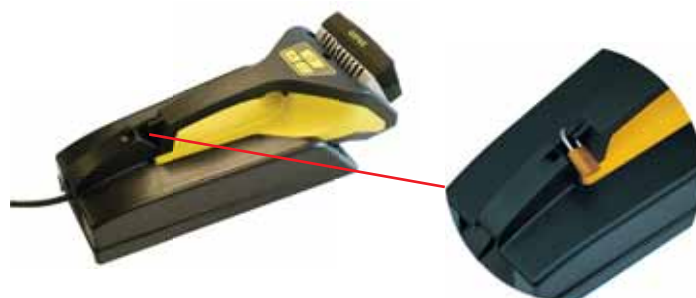
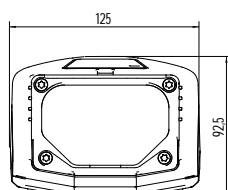
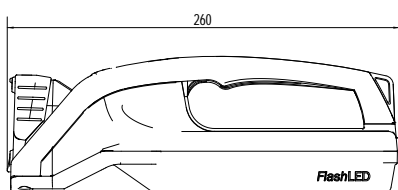

WorkLED 15 battery operated hand lamp



WorkLED is an inexpensive LED hand lamp, best-suited for professional use. Its versatility and state-of-the-art design makes it possible for us to offer an assortment of products for professional use as well as for daily use for crafts and hobbies.

Product features

- small and low weight for safe handling
- useful belt clip and hand strap
- sturdy construction
- magnet in the handle
- off and on switch
- unbreakable bracket

Technical data

Power supply:	230VAC
Electric power supply:	Battery pack NiMH
Charging time:	1h
Luminous period:	4h continuous operation
Lamps:	15 High-Power-LEDs white
Light output:	55lm
IP rating lamp:	IP65
Protection class:	-
Dimension (HxWxD):	181x60x35mm
Weight:	180g

Item	Designation
032359	WorkLED 15 battery hand lamp, incl. charger

WorkLED 80 battery operated hand lamp

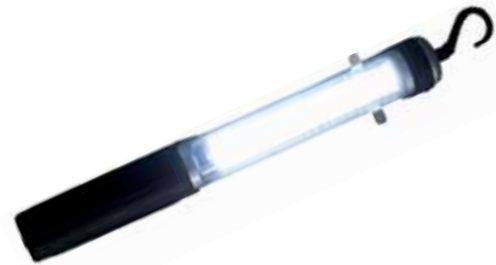

Best-suited for indoor and outdoor use, the WorkLED offers an optimal price/performance ratio: With its increased protection type of IP54 and 80 ultra-bright white LEDs, it leaves nearly nothing to be desired!

Product features

- on and off switch protected with rubber membranes
- charger plug with a captive protective cover
- sturdy design, with a protective rubber jacket
- break-proof folding and turning hook
- available with (rubber-coated) magnetic clamp
- 12V for charging in a vehicle and universal charger 230V are part of the scope of supply

Technical data

Power supply:	230VAC/24VDC/12VDC
Electric power supply:	Battery pack NiMH
Charging time:	1h
Luminous period:	3h continuous operation
Lamps:	80 High-Power-LEDs white
Light output:	140lm
IP rating lamp:	IP54
Protection class:	-
Dimension (DxL):	Ø45mmx437mm
Weight:	450g

Item	Designation
032365	WorkLED 80 battery hand lamp, incl. charger

Accessories / spare parts

037254	Magnetic clamp, rubber coated, incl. galvanized clamp, for WorkLED 80
037255	Substitute charger for WorkLED 80

STILO torch light



The lamp for engineers and technicians. No matter whether you inspect a car, replace a fuse or you are an industrial worker - the STILO does a good job. The lamp can be attached to shirt or workwear as fast as lightning and weighs so little that you'll hardly notice it. However, you will notice its brilliant, super-bright light which you can focus by turning the lamp head. The STILO is operated with two standard, inexpensive AAA micro cells.

Product features

- Power-LED
- very lightweight
- black, noble aluminium housing
- ergonomic and non-slip design with a ridged surface
- extremely bright, thanks to LED optics attachment
- excellent colour-rendering thanks to LED lens optics
- sturdy, impact and vibration resistant

Technical data

Power supply:	-
Electric power supply:	2x LR03 AAA/1.5V
Charging time:	-
Luminous period:	approx 3.6h
Lamps:	1x Power-LED
Light output:	20lm
IP rating lamp:	IP54
Protection class:	-
Dimension (length):	140mm
Weight:	60g (incl. batteries)

Item	Designation
035209	STILO torch light incl. batteries
Accessories / spare parts	
021811	Battery LR03 AAA/1.5V (apiece)



MINI torch light



The MINI Torch is small and lightweight; an energy-saving wonder but also a giant in terms of brightness. It is operated with a single mignon cell (AA). The integrated DC/DC converter pumps the voltage in nano-second intervals to the high-performance LED (3 Watt). The results are clear and exceed the light output by over 10 times that of heavier (more conventional) tubular torches.

Product features

- Power-LED
- very lightweight
- black, noble aluminium housing
- ergonomic and non-slip design with a ridged surface
- extremely bright, thanks to LED optics attachment
- excellent colour-rendering thanks to LED lens optics
- sturdy, impact and vibration resistant

Technical data

Power supply:	-
Electric power supply:	1x LR6 AA/1.5V
Charging time:	-
Luminous period:	approx 3h
Lamps:	1x Power-LED
Light output:	105lm
IP rating lamp:	IP54
Protection class:	-
Dimension (length):	115mm
Weight:	84g (incl. battery)

Item	Designation
034972	MINI torch light incl. batteries and belt pouch
Accessories / spare parts	
014118	Battery LR6 AA/1.5V (apiece)



MIDI torch light



The MIDI Torch was designed for professionals and users with extremely high demands. It is equipped with the Advanced Focus System and the newly developed one-hand slide base focussing mechanics. The torch can reach light output of 3 to 4 times that of conventional, heavy baton torches. You can choose between light that is stage-like, circular or can reach up to 500 meters distance of sharply focussed light. The MIDI was designed to be modular, is equipped with the Dynamic Switch (important for police and military) and has 2 levels of brightness.

Product features

- can be focussed using only one hand
- 2 levels of brightness
- black, noble aluminium housing
- ergonomical, handy and non-slip design with a ridged surface
- excellent colour-rendering thanks to LED lens optics
- sturdy, impact and vibration resistant

Technical data

Power supply:	-
Electric power supply:	4x LR03 AAA/1.5V
Charging time:	-
Luminous period:	approx 64h
Lamps:	1x Power-LED
Light output:	200lm
IP rating lamp:	IP54
Protection class:	-
Dimension (length):	133mm
Weight:	192g (incl. batteries)

Item	Designation
035350	MIDI torch light incl. batteries and belt pouch
Accessories / spare parts	
021811	Battery LR03 AAA/1.5V (apiece)



MAXI torch light



Our MAXI torch is equipped with the Dynamic Switch (3 levels of brightness) and a 39mm reflector lens. That is how, along with the new Super Light Chip, we attain a level of focus that an extraordinarily sharp, highly banded light beam is emitted into the night. But that is not all: if you adjust the lamp head, the concentration of light expands as if by magic into a circular, homogenous large area that makes uniform illumination of wide areas possible. The MAXI only requires 4 inexpensive alkaline mignon cells. This torch not only sets new standards in terms of light output and light banding, but also in terms of cost efficiency.

Product features

- compact design
- 3 levels of brightness
- black, noble aluminium housing
- ergonomical, handy and non-slip design with a ridged surface
- extremely bright due to the LED optics attachment

Technical data

Power supply:	-
Electric power supply:	4x LR6 AA/1.5V
Charging time:	-
Luminous period:	approx 104h
Lamps:	1x Power-LED
Light output:	210lm
IP rating lamp:	IP54
Protection class:	-
Dimension (length):	205mm
Weight:	384g (incl. batteries)

Item	Designation
039537	MAXI torch light incl. batteries and belt pouch
Accessories / spare parts	
014118	Battery LR6 AA/1.5V (apiece)



SECURITY torch light



The SECURITY torch is 39.5 centimetres long and weighs 1.488 grams – and provides amazing performance. Seven LED super chips, combined with seven terminator lenses provide extreme brightness that is highly unusual for an LED torch. Using 950 lumens, it illuminates very large areas or zones, but it is also able to focus on a specific spot. The Dynamic Switch provides perfect brightness control. The operating time with 4 mono-D batteries is up to 300 hours. The SECURITY is the ultimate Profi torch for the most difficult and challenging applications. An all-round perfect torch!

Product features

- 2 levels of brightness
- black, noble aluminium housing
- ergonomical, handy and non-slip design with a ridged surface
- extremely bright due to the LED optics attachment
- excellent colour-rendering thanks to LED lens optics
- sturdy, impact and vibration resistant

Technical data

Power supply:	-
Electric power supply:	4x LR20 D/1.5V
Charging time:	-
Luminous period:	approx 300h
Lamps:	7x Power-LED
Light output:	950lm
IP rating lamp:	IP54
Protection class:	-
Dimension (length):	395mm
Weight:	1'488g (incl. batteries)

Item	Designation
035186	SECURITY torch light incl. batteries and belt pouch
Accessories / spare parts	
024916	Battery LR20 D/1.5V (apiece)



FOREHEAD head lamp



With approximately 140 Lumen, this head lamp is a lighting wonder. This lightweight lamp is equipped with the best technology. You can switch the lamp from high beam to circular low beam. The convenient function of the Advanced Focus System makes outdoor activities much more pleasant and, above all, safer. The circular potentiometer allows for continuously variable dimming, the LED head can be swivelled by 90 degrees.

Product features

- can be swivelled by 90°
- can be switched from high beam to low beam
- continuously variable dimming
- battery box optimises weight counterbalance
- extremely bright, splash-proof
- incl. nylon bag
- excellent colour-rendering thanks to LED lens optics
- sturdy, impact and vibration resistant, also well-suited for jogging, for example

Technical data

Power supply:	-
Electric power supply:	3x LR03 AAA/1.5V
Charging time:	-
Luminous period:	approx 75h
Lamps:	1x Power-LED
Light output:	140lm
IP rating lamp:	IP54
Protection class:	-
Dimension (HxWxD):	Length adjustable
Weight:	117g (incl. batteries)

Item	Designation
035479	FOREHEAD head lamp incl. batteries and belt pouch
Accessories / spare parts	
021811	Battery LR03 AAA/1.5V (apiece)

MITRALUX L140



The handy, sturdy and reliable hand-held area light that supplies uniform light into the dark.

Product features

- evenly illuminated field of vision
- intense, white halogen light
- translucent, yellow polyamide housing
- maintenance-free accumulator with integrated electronic charging

Technical data

Power supply:	230VAC/12-24VDC and 12-18VAC
Electric power supply:	Lead battery 6V/12Ah
Charging time:	approx. 15h
Luminous period:	approx. 2.5h
Lamps:	Halogen micro projection lamp
Wide-angle lens:	f 50mm, field-Ø = distance: 1.5
Standard lens:	f 70mm, field-Ø = distance: 2.5
Tele lens:	f 125mm, field-Ø = distance: 5.0
Light output:	765lm
IP rating lamp:	IP54
Protection class:	-
Weight:	3'400g

Item	Designation
040695	MITRALUX L140, model ECONOMY, w/o accessories
040647	MITRALUX L140, model RELIANCE, w/o accessories
035425	MITRALUX L140, model EMERGENCY, w/o accessories

Accessories / spare parts

035138	Shoulder strap synthetic fiber, with cushion, adjustable
034440	Teletens for L140 strong convergence, up to 50m
035306	Wide angle lens for L140 close range up to 10m
038280	Plug-in power pack 230V/12VAC with Euro-plug, 2m cable
014019	Charging cable for permanent connection, 2m Kabel
040694	Charging cable for cigarette plug, 2m Kabel
040042	Wall holder V2A vertical for L140, glass bead blasted
048102	Wall holder V2A horizontal for L140, glass bead blasted
014002	Tripod holder 3/8"
014004	Tripod holder 1/4"
035843	Halogen lamp 6V/30W/G4
036198	Lead battery 6V/12'000mAh, maintenance-free
015100	Pressure switch, cpl. for L140 ECONOMY
015097	Pressure switch, cpl. for L140 RELIANCE
015099	Pressure switch, cpl. for L140 ECONOMY

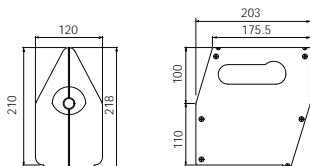

MULTI working lamp



The MULTI work lamp generates bright, evenly distributed light with its energy-saving fluorescent lamp and a mirror reflector. This helps to achieve glare-free surface lighting in the workspace.

Product features

- impact-resistant plastic housing with a high-quality rubber coating
- bright, evenly distributed light for glare-free lighting in the workspace
- integrated, rechargeable, maintenance-free accumulator
- integrated electronic charging for monitoring the charging process and protection against deep discharge or overloading
- battery charge indicator using light-emitting diodes
- 2 different connecting cables: 230V or 12V – cigarette lighter connection for optional charging in a vehicle

ATTENTION: any repairs may only be done by qualified personnel, e.g. replacing accumulators (danger of explosion).

Technical data

Power supply:	230VAC/12VDC
Electric power supply:	Lead accumulator 12V/7'200mAh
Charging time:	12h
Luminous period:	approx 3h
Lamps:	compact fluorescent light
Light output:	2'850lm
IP rating lamp:	IP54
Protection class:	II
Weight:	7'000g

Item	Designation
054976	MULTI rechargeable work lamp 38V without charger cable

Accessories / spare parts

054977	Charger and connection cable 230V/50Hz
054978	Charger and connection cable 12VDC
045189	Safety plexiglass
052509	Fluorescent lamp 2D, 38W/GRY10q-4
045190	Reflector
045194	Socket 2D
010768	Hand grip

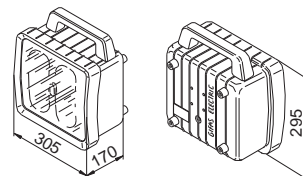

ApolloLIGHT PROFI



This special model offers additional possibilities as regards set-up and operation: besides being set up on a special stand, the ApolloLIGHT PROFI may also be operated when suspended!

Product features

- Additional functions as compared with the ApolloLIGHT STANDARD:
 - Operating mode: the ApolloLIGHT PROFI can be operated when suspended
 - Additional function: a selector switch allows you to choose between operating all of the bulbs and illuminating only one side (full power 8x80W as opposed to 4x80W)
 - Safety: The Profi design is equipped with protection against overheating and a built-in temperature switch

Technical data

Power supply:	230VAC
Power consumption (max.):	710W
Required generator power:	1000W
Full power after:	2min.
Service life of the lamps approx.:	8'000h
Light intensity:	20'780lm
IP rating:	IP44
Protection class:	I
Socket:	2G11
Weight:	9.5kg

Item	Designation
039214	ApolloLIGHT PROFI Wide Area Lighting System incl. cable 5m 3x1.5mm ² , plug typee 12 incl. carrying case
Accessories / spare parts	
102009	Tripod for ApolloLIGHT PROFI chrome steel, max. height 3.58m, with hand crank
039418	Carrying case for tripod 4 handles, measurements: 2100x400mm
033815	Wall holder V2A for ApolloLIGHT PROFI, ApolloLIGHT STANDARD
033073	Fluorescent lamp Dulux L, 80W/2G11
039276	Ballast 2x80W/220-240VAC

ApolloLIGHT STANDARD



The Apollo LIGHT Standard is a large area luminaire for all-round illumination. The standard design is well-suited for both interior and exterior applications. This model can be used everywhere and – together with the matching stand – provides maximum occupational safety with outstanding quality of illumination. The assembly can be permanently mounted to a building using a stainless steel wall mounting bracket.

Product features

- Efficient: Illumination area of up to 2,400 m². Good illumination increases the quality of work and reduces the risk of accidents – this ensures the safety of the work sites.
- Sturdy: high degree of stability, even with high wind speeds!
- Practical: does not take up a lot of space and can be ready for use without much effort. Delivered in an impact-resistant flight case
- Power sources: mains 230V/50Hz, generator / converter 12V/24V230V
- Installation: easy and very fast

Technical data

Power supply:	230VAC
Power consumption (max.):	660W
Required generator power:	1000W
Full power after:	2min.
Service life of the lamps approx.:	8'000h
Light intensity:	18'860lm
IP rating:	IP44
Protection class:	I
Socket:	2G11
Weight:	8.5kg

Item	Designation
081052	ApolloLIGHT STANDARD Wide Area Lighting System, incl. cable 5m 3x1.5mm ² , plug typee 12 incl. carrying case
Accessories / spare parts	
032339	Tripod for ApolloLIGHT STANDARD chrome steel, max. height 3.8m, with hand crank
039418	Carrying case for tripod 4 handles, measurements: 2100x400mm
033073	Fluorescent lamp Dulux L, 80W/2G11
039276	Ballast 2x80W/220-240VAC

Further information is available on request (Product Information documents 9|5)

Applications



ApolloLIGHT PROFI



ApolloLIGHT STANDARD



ApolloLIGHT PROFI



ApolloLIGHT STANDARD



FlashLED



FlashLED

PRIMA floodlight 38W/55W



The Prima light is a sophisticated, professional light with high light output with low heat emission as well as low energy consumption with a 2D compact fluorescent lamp. It guarantees the best area illumination with glare-free, evenly distributed light. Furthermore, it can be set up in a variety of ways for every use: suspended, flat or standing.

Product features

- yellow housing made of impact-resistant polycarbonate with black rubber edges for protection against shock or impacts
- carrying handle can also be used as a support and can bring the lamp into the desired position when locked in place
- Lamp cover made of Macrolon: shock and impact-resistant
- housing sealed against dust and water

Technical data

Version 38W:

Power supply: 230VAC/42-36VAC/12VDC
 Electric power supply: Line connector
 Lamps: compact fluorescent light: 38W/2D
 Light output: 2'850lm
 IP rating: IP65 (without socket)
 IP54 (with socket)

Protection class:
 I (230V with socket)
 II (230V without socket)
 III (24/42V without socket)

Dimension (HxWxD): 305x295x110mm
 Weight: approx 2'900g

Version 55W:

Power supply: 230VAC
 Electric power supply: Line connector
 Lamps: compact fluorescent light: 55W/2D
 Light output: 3'900lm
 IP rating: IP65 (without socket)
 IP54 (with socket)

Protection class:
 I (230V with socket)
 II (230V without socket)

Dimension (HxWxD): 305x295x110mm
 Weight: approx 2'900g

Special model 42-36VAC/38W and 12VDC/38W on request.

PRIMA 55W

Item	Designation	Socket	Lead	Plug
023451	230V/55W	-	-	-
012153	230V/55W	-	5m, 2x1.0mm ²	Type 11
012154	230V/55W	-	10m, 2x1.0mm ²	Type 11
021890	230V/55W	Type 13	-	-
012157	230V/55W	Type 13	5m, 3x1.0mm ²	Type 12
012161	230V/55W	Type 13	10m, 3x1.0mm ²	Type 12

PRIMA 38W

Item	Designation	Socket	Lead	Plug
045176	230V/38W	-	-	-
045201	230V/38W	-	5m, 2x1.0mm ²	Type 11
045207	230V/38W	-	10m, 2x1.0mm ²	Type 11
050886	230V/38W	-	5m, 2x1.0mm ²	Kontur
050887	230V/38W	-	10m, 2x1.0mm ²	Kontur
050999	230V/38W	Socket Type 13	-	-
045203	230V/38W	Socket Type 13	5m, 3x1.0mm ²	Type 12
065691	230V/38W	Socket Type 13	10m, 3x1.0mm ²	Type 12
051002	230V/38W	Socket Schuko	-	-
050812	230V/38W	Socket Schuko	5m, 3x1.5mm ²	Schuko
050849	230V/38W	Socket Schuko	10m, 3x1.5mm ²	Schuko
045208	24V/38W	-	-	-
045202	24V/38W	-	5m, 2x1.5mm ²	CEE 16/24V
050968	24V/38W	-	10m, 2x1.5mm ²	CEE 16/24V
045206	42V/38W (auch 36V)	-	-	-
045204	42V/38W	-	5m, 2x1.5mm ²	CEE 16/42V
050995	42V/38W	-	10m, 2x1.5mm ²	CEE 16/42V
045158	36-42V/38W	-	5m, 2x1.5mm ²	Type 6, 36V
045124	12V/38W	-	-	-
045144	12V/38W	-	5m, 2x1.5mm ²	Zig.Plug
045157	12V/38W	-	10m, 2x1.5mm ²	Zig.Plug

Accessories / spare parts PRIMA 38W/55W

106193	Support plate 3-points for PRIMA
106194	Linking bracket V2A for PRIMA incl. 2 star knobs
045174	Magnetic holder for wall/ceiling, 540N for 1 lamp PRIMA
045184	Holder for wall mounting for 1 lamp PRIMA
045188	Holder for ceiling mounting for 1 lamp PRIMA
010586	Light tripod standardheight 1.5-3.5m
045185	Tripod top part for 1 lamp PRIMA
045187	Tripod top part for 2 lamps PRIMA
047704	Eyelets M6x20 galvanised for PRIMA
045189	Safety plexiglass
052509	Fluorescent lamp 2D, 38W/GRY10q-4
041807	Fluorescent lamp 2D, 55W/GRY10q-4
045190	Reflector
053251	Starter 25-65W for PRIMA
045191	Low-loss ballast 230VAC/38W for PRIMA 230V/38W
018469	Electronic ballast 24VAC/38W for PRIMA 24V
018157	Electronic ballast 42VAC/38W for PRIMA 36-42V
050953	Electronic ballast 12VDC/38W for PRIMA 12V
011519	Electronic ballast 230VAC/55W for PRIMA 230V/55W
045194	Socket 2D
045199	Hand grip for PRIMA
047483	Connection socket cover, top for connection box type 13/Schuko
047491	Connection socket cover incl. Gasket
054973	Casing yellow / black body only, empty
054448	Protective film 0.6mm transparent (on plexiglass)

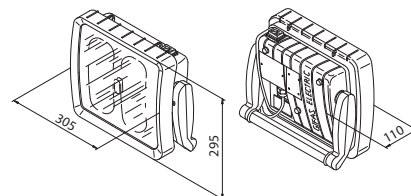

Ceiling bracket (screw fixing): Item 045188

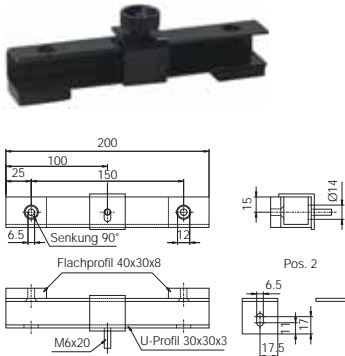

Ceiling mounting

Wall bracket (screw fixing): Item 045184

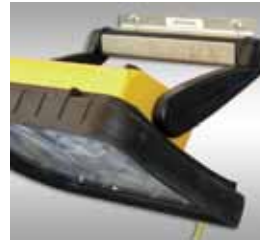
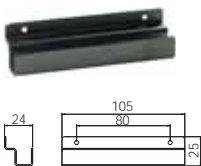

Wall mounting

Magnetic holder for wall or ceiling mounting: Item 045174

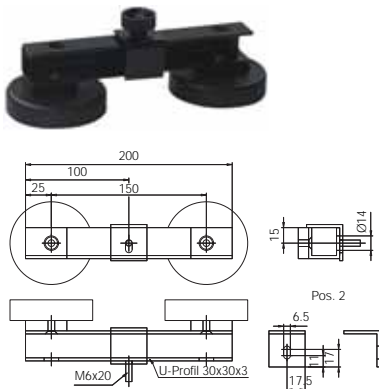

Magnetic holder

Tripod attachment for one lamp: Item 045185

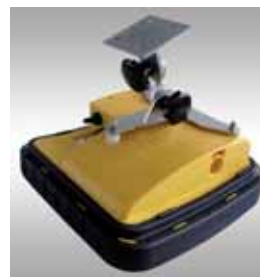

PRIMA with 3-Point-mounting plate V2A, horizontally and vertically adjustable: Item 106193 and 106194

Tripod attachment for two lamps: Item 045187

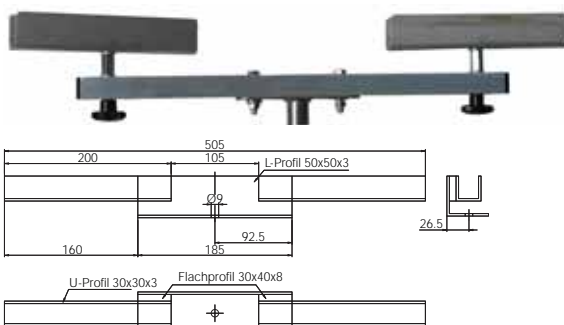

PRIMA panel light finished with 3 ring bolts (for chain, mount etc. provided by customer 3x Item 047704)



Use on tripod attachment Tripod: Item 010586

MULTI work light



The MULTI Work light is a sophisticated and professional light for industrial use. With its high light output (2x 2'800 lm) and low heat emission, it guarantees maximum area lighting with glare-free and bright white light. Various set-up options ensure a broad range of applications.

Product features

- black housing made of polycarbonate with a rubber coating and reinforced the edges
- handle makes it easy to carry and can also be used for easy mounting
- lamp cover made of Macrolon: shock and impact-resistant
- housing sealed against dust and water
- low energy consumption thanks to 72 Watt energy-saving lamps

Technical data

Power supply:	230VAC/24VAC/42VAC
Electric power supply:	Line connector
Lamps:	compact fluorescent light Dulux F
Light output:	2x2'800lm
IP rating:	IP65 (w/o socket) IP54 (with socket)
Protection class:	I (with socket) II (w/o socket)
Dimension (HxWxD):	295x305x170mm
Weight:	4'100g (230V) / 5'200g (24/42V)

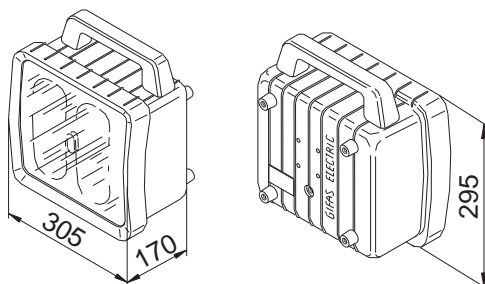

Item	Designation	Socket	Lead	Plug
052244	230V/2x36W		5m, 2x1.5mm ²	Type 11
052245	230V/2x36W		10m, 2x1.5mm ²	Type 11
046479	230V/2x36W		5m, 2x1.5mm ²	Kontur
046482	230V/2x36W		10m, 2x1.5mm ²	Kontur
049092	230V/2x36W	Socket Type 13	5m, 3x1.5mm ²	Type 12
049476	230V/2x36W	Socket Type 13	10m, 3x1.5mm ²	Type 12
046483	230V/2x36W	Socket Schuko	5m, 3x1.5mm ²	Schuko
046485	230V/2x36W	Socket Schuko	10m, 3x1.5mm ²	Schuko
046500	24V/2x36W		5m, 2x1.5mm ²	CEE 16A/24V
046501	24V/2x36W	Socket CEE 16A	5m, 2x2.5mm ²	CEE 16A/24V
046502	42V/2x36W		5m, 2x1.5mm ²	CEE 16A/42V
046503	42V/2x36W	Socket CEE 16A	5m, 2x2.5mm ²	CEE 16A/42V

Standard-Program*

055259	230V/2x36W		1m, 2x0.75mm ²	Type 11
	for wall mounting, excl. accessories			
055323	230V/2x36W		1m, 2x0.75mm ²	Type 11
	or ceiling mounting, excl. accessories			
055325	230V/2x36W		3m, 2x1mm ²	Type 11
	for chain mounting, excl. accessories			
055471	230V/2x36W		5m, 2x1mm ²	Type 11
	for chain mounting, excl. accessories			
055383	230V/2x36W		3m, 2x1mm ²	Type 11
	for fixed mounting, excl. accessories			
055417	230V/2x36W		5m, 2x1.5mm ²	Type 11
	for fixed mounting, excl. accessories			

Accessories / spare parts

047704	Eyelets M6x20 galvanised
024315	Magnetic clamp 540N (incl. screws)
053618	Wall / ceiling mounting plate
054230	Tripod top part for 2 lamps MULTI (per lamp additional Tripod/wall holder aluminium bracket Item 051630)
051630	Tripod/wall holder aluminium bracket
054986	Pivoting wall holder, A2
059916	Tripod wall holder bracket, promatised steel
045189	Safety plexiglass (for repair / maintenance order each additional rubber seal!)
054121	Gasket
048126	Fluorescent lamp Dulux F, 36W/2G10
051406	Electronic ballast 230VAC/2x36W(1x per lamp MULTI)
010237	Transformer 230V/24V/70VA
052299	Reflector with 2 lamp sockets

* the spare parts must be ordered separately



Magnet: Item 024315



Combinable with magnets



Wall/ceiling mounting plate: Item 053618



Ceiling or wall mounting with wall/ceiling mounting plate



Wall/ceiling holder pivotable, A2 Item 054986



Wall/ceiling holder pivotable



Tripod-/wall mounting bracket aluminium, Item 051630



Tripod-/wall mounting bracket



Tripod-/wall mounting bracket galvanized, Item 059916



Suspended version using 4 ring bolts (4x Item 047704, chains suspension, etc. provided by customer)



Tripod attachment for 2 MULTI working lamps Item 054230 (per lamp 1 additional attachment Item 51630)

FL Tubular lamp 36W



The FL 36W is a conventional tube torch with fluorescent tube and ballast and consists of a sturdy shock and impact-proof construction. It is oil and acid-resistant and it is well-suited to a variety of applications.

Product features

- grip and cover made of insulating material with shock-absorbing protective edges
- transparent tube made of unbreakable polycarbonate
- glare-free work light that is distributed across a long distance
- built-in electronics with protection module
- practical suspension with swivelling hook
- impervious to fluctuations in temperature
- Resistant to oil, acid and ageing, self-extinguishing

Technical data

Power supply:	230VAC
Electric power supply:	Line connector
Lamps:	fluorescent tube T8
Light output:	2'600lm
IP rating:	IP55
Protection class:	II
Weight:	2'000g (w/o cable)

Item	Designation	Lead	Plug
010448	FL 230V/36W	5m, 2x1.0mm ²	Type 11
010449	FL 230V/36W	10m, 2x1.0mm ²	Type 11
050892	FL 230V/36W	5m, 2x1.0mm ²	contour
050894	FL 230V/36W	10m, 2x1.0mm ²	contour
010447	FL 230V/36W	without	-

Accessories / spare parts

017513	Suspension bracket V2A special (img. S. 17)
012316	Magnetic clamp 290N incl. clamp buckle, Ø50mm (img S. 17)
020323	Cap with suspension hook
010467	Fluorescent tube T8, 36W/G13
045753	Safety tube (l=1'500mm/Ø50mm)
010468	Ballast 230V/36W for FL tubular lights 36W

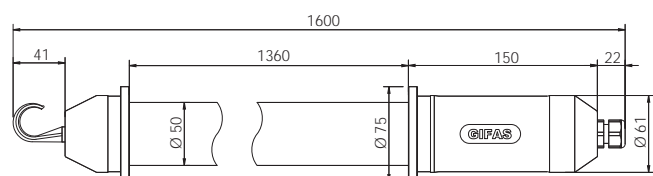

PLC Tubular lamp 18W



PLC is a compact and handy energy-saving lamp with high light output. It is well-suited to a variety of applications, e.g. as a work light, search light or inspection light.

Product features

- grip and cover made of insulating material with shock-absorbing protective edges
- transparent tube made of unbreakable polycarbonate
- compact dimensions
- practical suspension with swivelling hook
- good initial starting thanks to electronic ballast
- impervious to fluctuations in temperature

Technical data

Power supply:	230VAC
Electric power supply:	Line connector
Lamps:	compact fluorescent light 2D
Light output:	1'140lm
IP rating:	IP55
Protection class:	II
Weight:	1'000g (w/o cable)

Item	Designation	Lead	Plug
017299	PLC 230V/18W	5m, 2x1.0mm ²	Type 11
018258	PLC 230V/18W	10m, 2x1.0mm ²	Type 11
050895	PLC 230V/18W	5m, 2x1.0mm ²	Kontur
050897	PLC 230V/18W	10m, 2x1.0mm ²	Kontur
019711	PLC 230V/18W	without	-

Accessories / spare parts

017513	Suspension bracket V2A special (img. S. 17)
012316	Magnetic clamp 290N incl. clamp buckle, Ø50mm (img S. 17)
020323	Cap with suspension hook
017627	Hose clamp for PLC tubular lights
010474	Knob for PLC, DULUX
105344	Fluorescent lamp 2D, 18W/G24q2
017628	Safety tube (L=250mm/Ø50mm)
043799	Circular holder made of white nitril-caoutchouc
105349	Socket G24-Q2
105350	Electronic ballast 230V/18-21W for PLC tubular lights
105352	Aluminium clamp for control gear and socket

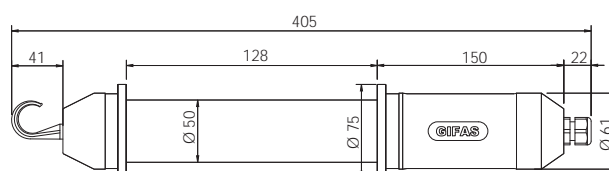

DULUX Tubular lamp 18W, 36W, 40W



The DULUX series is distinguished through its low energy consumption while producing an extremely high light output. It is well-suited to a variety of applications, e.g. in industry.

Product features

- grip and cover made of insulating material with shock-absorbing protective edges
- transparent tube made of unbreakable polycarbonate
- glare-free work light that is distributed across a long distance
- practical suspension with swivelling hook
- impervious to fluctuations in temperature
- built-in electronics with protection module (for 40 W with EB)

Technical data

Power supply:	230VAC (18/40W) 42VDC (18/36W) 24VDC (18/36W)
Electric power supply:	Line connector
Lamps:	compact fluorescent light Dulux L Type L / socket typee 2G11
Light output:	1'200lm (18W) 3'500lm (36/40W)
IP rating:	IP55
Protection class:	II
Dimension DULUX 18W:	A = 500mm B = 230mm
Dimension DULUX 36/40W:	A = 1'100mm B = 830mm
Weight DULUX 18W:	600g
Weight DULUX 36/40W:	1'100g

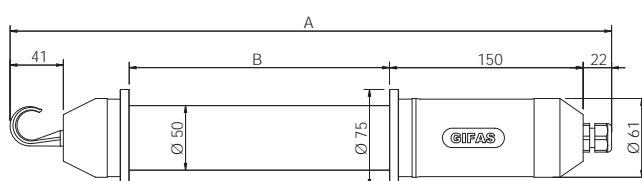

Item	Designation	Lead	Plug
040700	230V/18W	5m, 2x1.0mm ²	Type 11
040800	230V/40W	5m, 2x1.0mm ²	Type 11
050890	230V/18 W	5m, 2x1.0mm ²	contour
050891	230V/40W	5m, 2x1.0mm ²	contour
040550	24V/18W	5m, 2x1.5mm ²	CEE 16/24V
051040	24V/36W	5m, 2x1.5mm ²	CEE 16/24V
050878	42V/18W	5m, 2x1.5mm ²	CEE 16/42V
051041	42V/36W	5m, 2x1.5mm ²	CEE 16/42V
042404	24V/18W	without	-
051031	24V/36W	without	-
050879	42V/18W	without	-
051032	42V/36W	without	-
040198	230V/18W	without	-
040850	230V/40W	without	-

Accessories / spare parts

017513	Suspension bracket V2A special (img. p. 17)
012316	Magnetic clamp 290N incl. clamp buckle, Ø50mm (img S. 17)
020323	Cap with suspension hook
055738	Safety tube (l=340mm/Ø50mm)
043045	Hose clamp / small clip
010474	Knob for PLC, DULUX
040090	Fluorescent lamp Dulux L, 18W/2G11
040510	Fluorescent lamp Dulux L, 40W/2G11
040092	Fluorescent lamp Dulux L, 36W/2G11
045751	Safety tube (l=885mm/Ø50mm)
040058	Electronic ballast 18W
011644	Electronic ballast 36-40W
012756	Microfuse 500mA



Magnetic clamp
Item. 012316



Suspension bracket V2A special
Item. 017513



Halogen hand-held spotlight 100W



This is a powerful and compact hand-held lamp, especially well-suited for use as a search or inspection light or anywhere where light is required across long distances.

Product features

- safety insulated and impact-proof light body with a suspension ring
- ergonomically designed handle with a combination switch for continuous lighting and pulse operation
- spotlight with narrow, constricted light cone up to 250m

Technical data

Power supply:	230VAC/24VDC/12VDC
Electric power supply:	Line connector / cigarette plug
Lamps:	halogen reflector lamp 100W
Light output:	110'000cd (12V) / 70'000cd (24V)
IP rating:	IP55
Protection class:	III
Dimension:	-
Weight:	900g (without cable)

Item	Designation	Lead	Plug
017277	24V/100W (230V)	5m, 2x0.75mm ²	Plugtrafo Euro
010509	12V/100W	10m, 2x1.0 mm ²	cig. plug
010513	24V/100W	10m, 2x1.0 mm ²	cig. plug
050970	24V/100W	5m, 2x1.5 mm ²	CEE 16/24V
050971	12V/100W	without	-
028022	24V/100W	without	-

Other cable length on request

Accessories / spare parts

010517	Protective grid chrome-plated
011185	Cigarette plug <50V/8A/2P
017035	Plug-in transformer 230VAC/24VDC, 50-100W
010544	Halogen reflector lamp 13V/100W/G53
010545	Halogen reflector lamp 28V/100W/G53
010579	Flip switch with rubber cap
010559	Rubber cap for flip switch
010576	Keyring nickel-plated (38mm)
010581	Rubber light casing

Additional options



Item 011884

In accordance with applicable regulations, energy consumers with corresponding protective screening must be used in rooms with materials that have good conductivity.

Halogen Hand-Held Spotlight with Cable reel

- The combination "Halogen hand-held spotlight with cable reel" is especially well-suited for use in inspection work in metal compartments like boilers, vessels, containers etc
- Feature: The safety transformer is integrated into the cable reel body

Mobile Safety Transformer

- Another possibility is the use of a mobile safety transformer.

Item	Designation
050944	Hand-held spotlight with cable reel complete, fitted with: 25m cable, 2x2.5mm ² on main reel, toroidal transformer 230/24V-120VA integrated, lead 3m, 2x1.5mm ² (w/o plug) on auxiliary reel
011884	Safety transformer, casing 2516, fitted with: service socket T13/230V, outgoing socket CEE 16/24 V, integrated isolating transformer 230/24V-120VA, with fuse, grip and uncoiler, with 3m lead, 3x1mm ² , plug T12
050946	Safety transformer, casing 2516, fitted with: service socket Schuko/230V, outgoing socket CEE 16/24V, integrated isolating transformer 230/24V-120VA, with fuse, grip and uncoiler, with 3m lead, 3x1mm ² , plug Schuko

Important! The relevant usage regulations must be observed when using these additional options!

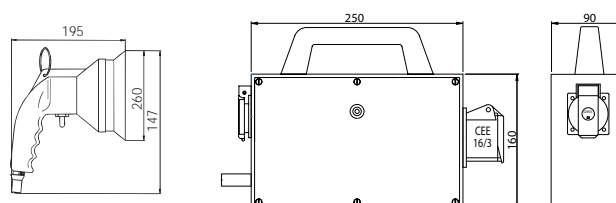

Applications



MULTI



MULTI



MULTI



MULTI



PRIMA



PRIMA

GIFAS Safety tubular lights



GT70

The standard safety tubular lights were developed to be mounted onto or into machines. However, they are just as well-suited for lighting switchboards and control panels. Other applications include wet rooms, tunnels, alcoves, water purification plants, water reservoirs. etc. The safety tubular lights provide glare-free light. Based on their high protection class, they also work trouble-free and maintenance-free under extreme conditions. Models are available with bodies made of plexiglass or borosilicate glass. The ballasts (EBs) are integrated or can be fixed externally.

GT70 short

There is a short version for particularly tight areas of application. The power of the bulb body remains the same, only the length is reduced. This can be done by using special ballasts that are installed under the bulb (in contrast to the standard version where the ballast is next to the bulb).

StreamLIGHT

This model has a smaller outside diameter giving it a more elegant look. Just like the GT safety tubular lights, the StreamLIGHT is also available with a Plexiglass or glass housing, and T8, T5 and Dulux compact bulbs can be used.

StreamLED

Thanks to LED technology, this is an economical alternative to the conventional safety tube lights and is particularly well-suited for workshops, large-scale industrial areas, shops, warehouses, supermarkets, cold stores, hospitals, medical clinics, museums, etc.

StreamLIGHT/StreamLED

These types are also available in IP68. For this purpose, they are equipped with a lead of 40cm with socket IP68. An appropriate plug IP68 is also included in the delivery. Item, price and availability on demand.

Various ballasts:

Lamp with electronic ballast (EB) (is installed next to the bulb)



Lamp in short version: electronic ballast (is mounted behind the tube)



LED lamp: without ballast

Various lamp types:

Fluorescent tube, T8 (Ø26mm)



Fluorescent tube, T5 (Ø16mm)



Dulux compact tube



LED tube



Product features GT, GT short, and StreamLIGHT

- energy-saving fluorescent tube for glare-free light: tubular fluorescent bulb type 8 and type 5 as well as Dulux compact fluorescent bulb
- thanks to the more compact Dulux bulb (in contrast to type 8 and type 5), it is possible to have the same power with a shorter total length
- solid and sturdy construction: all screws and brackets in stainless steel, lamp bodies made of impact-resistant Plexiglass or borosilicate glass, resistant to chemical and mechanical influences
- large selection of different levels of power, lengths and voltage
- ballasts can be built-in or mounted on the outside
- cover plates made of glass-fibre reinforced nylon 66: dust-proof and water-tight, even for extreme operating conditions, trouble-free and maintenance-free

Type	Outer Ø	Tube	Cap colour	Wall bracket	Voltage	Output	Lamp types	IP rating
GT 70	70mm	Borosilicateglass or Plexiglass imp.proof	blue	additional item	230VAC/24VAC	11W-2x54W	T5 / T8 / Dulux	IP67
GT 70 short	70mm	Borosilicateglass or Plexiglass imp.proof	blue	additional item	230VAC/24VAC on request	18W-2x54W	T5 / T8 / Dulux	IP67
StreamLIGHT	54mm	Borosilicateglass or Plexiglass imp.proof	anthracite	integrated	230VAC/24VAC on request	18W-55W	T5 / T8 / Dulux	IP67*
StreamLED	54mm	Plexiglass imp.proof	anthracite	integrated	150 - 240VDC or 24VDC	9W-24W	LED	IP67*

*Protection class IP68 available on request.

GT 70

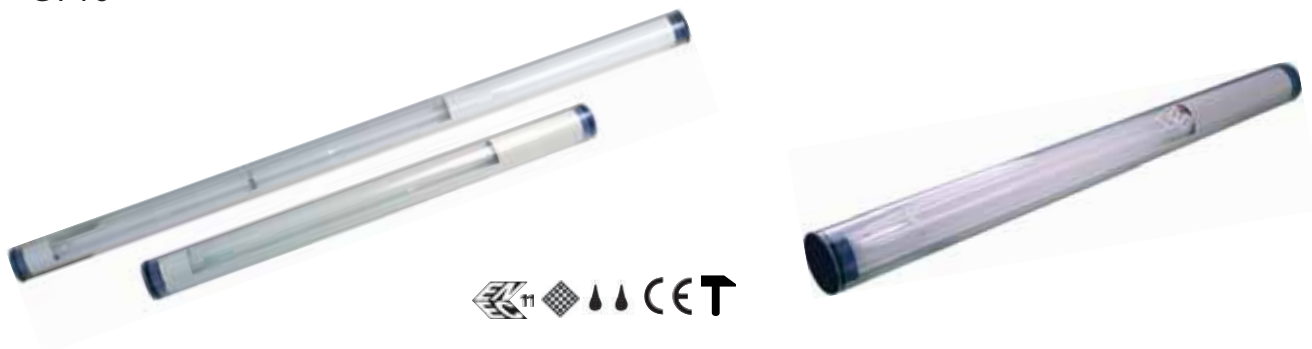

GT 70 with T8

Item	Lamps	IP rating	Voltage	Output	Ballast ¹⁾	Tube type	Length L1	Length L2	Light output
016158	Tubular shape / T8	IP67	230VAC	18W	EB integrated	Plexiglass	842mm	565mm	1'350lm
046199	Tubular shape / T8	IP67	230VAC	36W	EB integrated	Plexiglass	1'577mm	1'180mm	3'350lm
046200	Tubular shape / T8	IP67	230VAC	58W	EB integrated	Plexiglass	1'874mm	1'180mm	5'200lm
016159	Tubular shape / T8	IP67	230VAC	18W	EB integrated	Glass tube	842mm	565mm	1'350lm
046217	Tubular shape / T8	IP67	230VAC	36W	EB integrated	Glass tube	1'577mm	1'180mm	3'350lm
046222	Tubular shape / T8	IP67	230VAC	58W	EB integrated	Glass tube	1'874mm	1'480mm	5'200lm

GT 70 with T5

020016	Tubular shape / T5	IP67	230VAC	39W	EB integrated	Plexiglass	1'382mm	860mm	3'500lm
019277	Tubular shape / T5	IP67	230VAC	54W	EB integrated	Plexiglass	1'682mm	1'160mm	5'000lm
020018	Tubular shape / T5	IP67	230VAC	80W	EB integrated	Plexiglass	1'982mm	1'517mm	7'000lm
058245	Tubular shape / T5	IP67	230VAC	2x39W	EB integrated	Plexiglass	1'382mm	860mm	7'000lm
020022	Tubular shape / T5	IP67	230VAC	2x54W	EB integrated	Plexiglass	1'682mm	1'160mm	10'000lm
020017	Tubular shape / T5	IP67	230VAC	39W	EB integrated	Glass tube	1'382mm	860mm	3'500lm
019278	Tubular shape / T5	IP67	230VAC	54W	EB integrated	Glass tube	1'682mm	1'160mm	5'000lm
020019	Tubular shape / T5	IP67	230VAC	80W	EB integrated	Glass tube	1'982mm	1'517mm	7'000lm
020020	Tubular shape / T5	IP67	230VAC	2x39W	EB integrated	Glass tube	1'382mm	860mm	7'000lm
020024	Tubular shape / T5	IP67	230VAC	2x54W	EB integrated	Glass tube	1'682mm	1'160mm	10'000lm

GT 70 with Dulux

046125	Compact / Dulux	IP67	230VAC	11W	EB integrated	Plexiglass	330mm	230mm	900lm
016156	Compact / Dulux	IP67	230VAC	18W	EB integrated	Plexiglass	415mm	240mm	1'200lm
016164	Compact / Dulux	IP67	230VAC	24W	EB integrated	Plexiglass	526mm	340mm	1'800lm
046132	Compact / Dulux	IP67	230VAC	36W	EB integrated	Plexiglass	745mm	430mm	2'900lm
019445	Compact / Dulux	IP67	230VAC	55W	EB integrated	Plexiglass	1'032mm	527mm	4'800lm
046134	Compact / Dulux	IP67	230VAC	11W	EB integrated	Glass tube	330mm	230mm	900lm
016157	Compact / Dulux	IP67	230VAC	18W	EB integrated	Glass tube	415mm	240mm	1'200lm
016165	Compact / Dulux	IP67	230VAC	24W	EB integrated	Glass tube	526mm	340mm	1'800lm
046137	Compact / Dulux	IP67	230VAC	36W	EB integrated	Glass tube	745mm	430mm	2'900lm
019446	Compact / Dulux	IP67	230VAC	55W	EB integrated	Glass tube	1'032mm	527mm	4'800lm

GT 70 loop version with Dulux

049412	Compact / Dulux	IP67	230VAC	36W	EB integrated	Plexiglass	867mm	430mm	2'900lm
051563	Compact / Dulux	IP67	230VAC	55W	EB integrated	Plexiglass	967mm	550mm	4'800lm
051666	Compact / Dulux	IP67	230VAC	36W	EB integrated	Glass tube	867mm	430mm	2'900lm
051665	Compact / Dulux	IP67	230VAC	55W	EB integrated	Glass tube	967mm	550mm	4'800lm

1) EB = electronic ballast, mounted next to the bulb

Additional designs, e.g. low voltage 24/48VAC/VDC or without ballasts are available upon request.

Tubular shape design

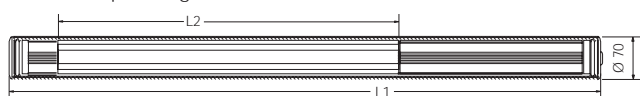

Compact design

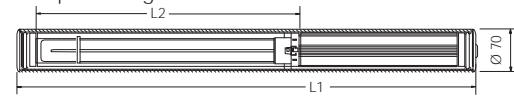

loop design

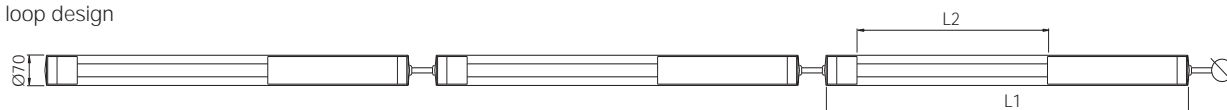

GT 70 short



GT 70 short with T8

Item	Lamps	IP rating	Voltage	Output	Ballast ¹⁾	Tube type	Length L1	Length L2	Light output
024941	Tubular shape / T8	IP67	230VAC	18W	EB integrated	Plexiglass	772mm	585mm	1'350lm
024942	Tubular shape / T8	IP67	230VAC	36W	EB integrated	Plexiglass	1'382mm	1'200mm	3'350lm
024943	Tubular shape / T8	IP67	230VAC	58W	EB integrated	Plexiglass	1'682mm	1'500mm	5'200lm
024944	Tubular shape / T8	IP67	230VAC	18W	EB integrated	Glass tube	772mm	585mm	1'350lm
024945	Tubular shape / T8	IP67	230VAC	36W	EB integrated	Glass tube	1'382mm	1'200mm	3'350lm
024946	Tubular shape / T8	IP67	230VAC	58W	EB integrated	Glass tube	1'682mm	1'500mm	5'200lm

GT 70 short with T5

024951	Tubular shape / T5	IP67	230VAC	2x39W	EB integrated	Plexiglass	1'006mm	849mm	7'000lm
024952	Tubular shape / T5	IP67	230VAC	2x39W	EB integrated	Glass tube	1'006mm	849mm	7'000lm

GT 70 short with Dulux

024947	Compact / Dulux	IP67	230VAC	24W	EB integrated	Plexiglass	440mm	291mm	1'800lm
024948	Compact / Dulux	IP67	230VAC	36W	EB integrated	Plexiglass	550mm	391mm	2'900lm
025023	Compact / Dulux	IP67	230VAC	55W	EB integrated	Plexiglass	672mm	507mm	4'800lm
024949	Compact / Dulux	IP67	230VAC	24W	EB integrated	Glass tube	440mm	291mm	1'800lm
024950	Compact / Dulux	IP67	230VAC	36W	EB integrated	Glass tube	550mm	391mm	2'900lm
025024	Compact / Dulux	IP67	230VAC	55W	EB integrated	Glass tube	672mm	507mm	4'800lm

1) EB = electronic ballast, mounted next to the bulb

Tubular shape design

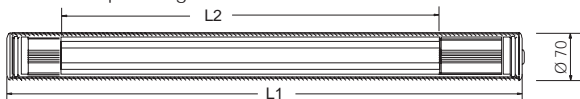

Compact design

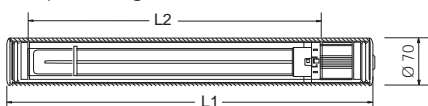

StreamLIGHT



StreamLIGHT with T8 (Ø26mm)

Item	Lamps	IP rating	Voltage	Output	Ballast	Tube type	Length L1	Length L2	Light output
032765	Rod shaped / T8	IP68/3bar	230VAC	18W	EB integrated	Plexiglass	1'013mm	559mm	1'350lm
032766	Rod shaped / T8	IP68/3bar	230VAC	36W	EB integrated	Plexiglass	1'759mm	1'169mm	3'350lm
032767	Rod shaped / T8	IP68/3bar	230VAC	58W	EB integrated	Plexiglass	2'057mm	1'469mm	5'200lm
032768	Rod shaped / T8	IP68/3bar	230VAC	18W	EB integrated	Glass tube	1'013mm	559mm	1'350lm
032769	Rod shaped / T8	IP68/3bar	230VAC	36W	EB integrated	Glass tube	1'761mm	1'169mm	3'350lm
032770	Rod shaped / T8	IP68/3bar	230VAC	58W	EB integrated	Glass tube	2'057mm	1'469mm	5'200lm

StreamLIGHT with T5 (Ø16mm)

030933	Rod shaped / T5	IP68/3bar	230VAC	24W	EB integrated	Plexiglass	964mm	508mm	1'750lm
030934	Rod shaped / T5	IP68/3bar	230VAC	39W	EB integrated	Plexiglass	1'398mm	808mm	3500lm
030935	Rod shaped / T5	IP68/3bar	230VAC	54W	EB integrated	Plexiglass	1'696mm	1'108mm	5'000lm
030936	Rod shaped / T5	IP68/3bar	230VAC	80W	EB integrated	Plexiglass	1'998mm	1'408mm	7'000lm
030937	Rod shaped / T5	IP68/3bar	230VAC	24W	EB integrated	Glass tube	964mm	508mm	1'750lm
030938	Rod shaped / T5	IP68/3bar	230VAC	39W	EB integrated	Glass tube	1'398mm	808mm	3500lm
030939	Rod shaped / T5	IP68/3bar	230VAC	54W	EB integrated	Glass tube	1'696mm	1'108mm	5'000lm
030940	Rod shaped / T5	IP68/3bar	230VAC	80W	EB integrated	Glass tube	1'998mm	1'408mm	7'000lm

StreamLIGHT with Dulux - Compact

032771	Compact / Dulux	IP68/3bar	230VAC	18W	EB integrated	Plexiglass	612mm	277mm	1'200lm
032772	Compact / Dulux	IP68/3bar	230VAC	24W	EB integrated	Plexiglass	712mm	377mm	1'800lm
032773	Compact / Dulux	IP68/3bar	230VAC	36W	EB integrated	Plexiglass	941mm	471mm	2'900lm
032774	Compact / Dulux	IP68/3bar	230VAC	55W	EB integrated	Plexiglass	1'063mm	593mm	4'800lm
032775	Compact / Dulux	IP68/3bar	230VAC	18W	EB integrated	Glass tube	612mm	277mm	1'200lm
032776	Compact / Dulux	IP68/3bar	230VAC	24W	EB integrated	Glass tube	712mm	377mm	1'800lm
032777	Compact / Dulux	IP68/3bar	230VAC	36W	EB integrated	Glass tube	941mm	471mm	2'900lm
032778	Compact / Dulux	IP68/3bar	230VAC	55W	EB integrated	Glass tube	1'063mm	593mm	4'800lm

All 3 types (T8, T5 and Dulux) can be used as chain lights in a "loop version". Particular attention was paid to this application when the cable guide duct was being developed.

Additional versions, e.g. low voltage 24VAC, without ballasts or looping are available upon request.

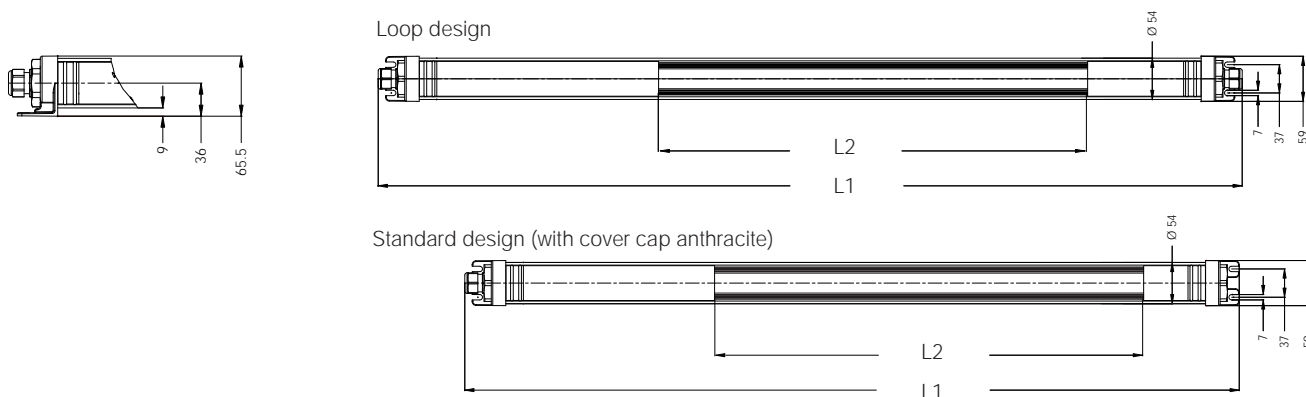

StreamLED



Product features

- Reduced energy consumption
- 40% lower heat emission than for fluorescent lights
- Certifications*: TÜV, EMV, VDE, RoHS and CE
- 2 years' product warranty (depending on area of application)
- Starters and ballasts are not necessary
- High-quality, patented LEDs are used
- The light output remains the same regardless of outside temperature
- Unbreakable (work safety)
- No UV rays
- about 50'000 operating hours
- Temperature range -30°C up to +50°C

Technical data

Power supply: 150-240VAC oder 24VDC
 Electric power supply: Line connector
 Lamps: Power-LED à 0.06W (4'000K)
 Power: 9W, 20W oder 24W
 IP rating: IP68 / 3bar
 Protection class: II
 Weight: -



Item	Lamps	IP rating	Voltage	Output	Number of LED	Tube type*	Length	Light output	Beam Angles
104442	LED	IP67	150-240VAC	9W	130	Plexiglass	848mm	800lm	120°
039598	LED	IP67	150-240VAC	20W	280	Plexiglass	1'458mm	1'550lm	120°
104448	LED	IP67	150-240VAC	24W	340	Plexiglass	1'758mm	1'900lm	120°
105268	LED	IP67	24VDC	20W	280	Plexiglass	1'458mm	1'550lm	120°

*Borosilicateglass version on request

Option Wall-/ceiling suspension

Alternative to the covering cap with integrated mounting base you can use a customary clamp for the wall-/ceiling suspension. The retaining cover cap should be applied as well (item see page 25).

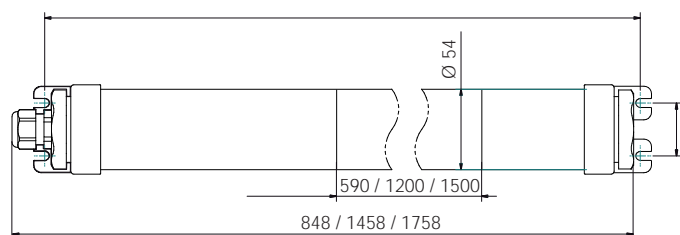

StreamLED with cover cap and clamp

Accessories



Item 046224

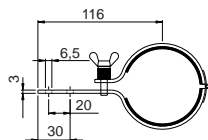

Item 046177

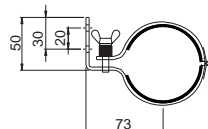

Item 046178

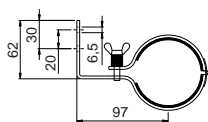

Item 046182

Item 046181

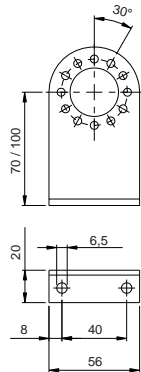

Item 102800

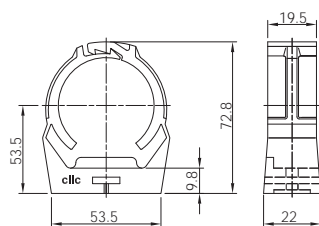

Item 103355

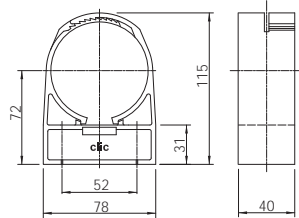

Item 103110 / 102800

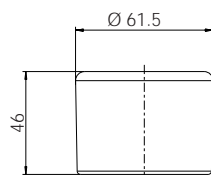

Accessories for GT 70, GT 70 short

Item	Designation
046224	Holder A4, Ø70mm / straight attachment fitting
046177	Holder A4, Ø70mm / wall fitting type 1
046178	Holder A4, Ø70mm / wall fitting type 2
046181	Holder A4, Ø70mm / positioning bracket type 1
046182	Holder A4, Ø70mm / positioning bracket type 2
103355	Clamp synthetic type 63, Ø63-71mm
049566	Cover cap synthetic blue incl. cable gland M20
050151	Cover cap synthetic blue excl. cable gland
054998	O-Ring gasket, made of Viton

Accessories for GT 70, GT 70 short and StreamLIGHT

Item	Designation
052065	Fluorescent tube T8, 18W/G13
050911	Fluorescent tube T8, 36W/G13
051312	Fluorescent tube T8, 58W/G13
020204	Fluorescent tube T5, 39W/G5
020205	Fluorescent tube T5, 54W/G5
020206	Fluorescent tube T5, 80W/G5
040737	Fluorescent lamp Dulux S/E, 11W/2G7
040090	Fluorescent lamp Dulux L, 18W/2G11
051713	Fluorescent lamp Dulux L, 24W/2G11
040092	Fluorescent lamp Dulux L, 36W/2G11
040510	Fluorescent lamp Dulux L, 40W/2G11
052064	Fluorescent lamp Dulux L, 55W/2G11

Accessories for StreamLIGHT, StreamLED

Item	Designation
032925	Cover cap anthracite incl. cable glands M20
032926	Cover cap anthracite excl. cable glands
032927	Cover cap grey incl. cable glands M20
032928	Cover cap grey excl. cable glands
033284	Hexagon wrench key for fixing of the cover caps
102800	Clamp synthetic type 51, Ø51-55mm
103110	Cover cap synthetic anthracite type 54

Accessories for StreamLED

Item	Designation
102048	LED-tube 230V/9W
102050	LED-tube 230V/20W
102051	LED-tube 230V/24W
102052	LED-tube 24VDC/20W

Further spare or separate parts such as safety tube (Plexiglass or glass) on request.

FL-lamp for wet environments



We offer strong light fittings, suitable for wet use, for fixed or mobile installation. They can be used in workshops, garages, industrial plants as well as on construction sites, for indoor and outdoor lighting, to be mounted on ceilings or walls.

Product features

- Housing and cover made of grey polycarbonate
- impact-resistant and self-extinguishing
- transparent cover, non-yellowing, UV-stabilised
- all metal parts (closures) made of stainless steel
- operates at temperatures up to 85°C
- ballasts compensated

Technical data

Power supply:	230VAC
Electric power supply:	Line connector
Lamps:	fluorescent tube T8
Light output:	3'000 oder 6'000lm
IP rating:	IP65
Protection class:	I
Weight:	2'450g (1x36W w/o cable) 4'300g (2x36W w/o cable)
Temperature class Type 4:	max. 135°C temporary (EN 60598-1)

Item	Designation
053070	1x36W, CB*, without lamps, cable and plug
053071	2x36W, CB*, without lamps, cable and plug
055520	1x36W, EB*, without lamps, cable and plug
055530	2x36W, EB*, without lamps, cable and plug
Accessories / spare parts	
010467	Fluorescent tube T8, 36W/G13
045230	Polycarbonate cover 1x36W
045231	Polycarbonate cover 2x36W
045234	Suspension fixing set

* CB = Conventional ballast / EB = Electronic ballast
Different versions available

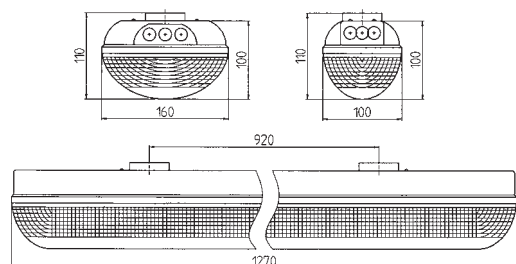

Application



FL-lamp for wet environments



FL-lamp for wet environments

GT Tubular light



Tubular light with elevated IP rating

Applications



StreamLED



GT Tubular light



GT Tubular light



GT Tubular light

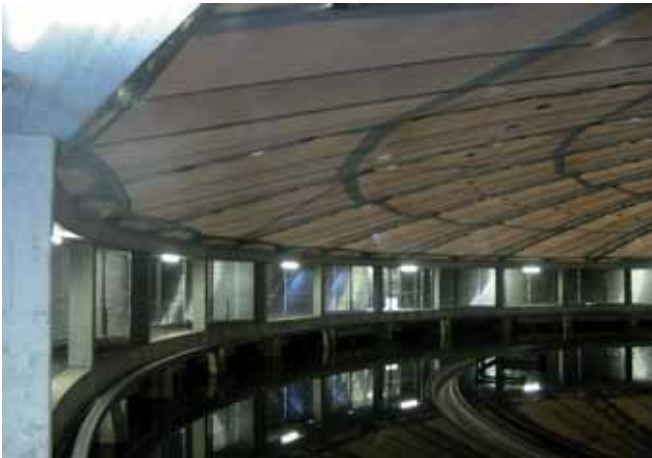

GT Tubular light



StreamLED

META Workplace Light



Type 1
(with 1 hinge)



Type 2
(with 2 hinges)



Type 3
(with 3 hinges)

This workplace light is extremely sturdy (with shatterproof glass), visually appealing and available in three different designs. It is also more impermeable (IP65). With its various articulated arms – both rotating and swivelling – it is the right light for many applications. It is particularly well-suited for work areas or machines in which coolants or other liquids are used.

Product features

- shatterproof safety glass
- lamp body made of aluminium
- On/Off switch mounted on the back of the lamp head
- handle made of polyamide
- is able to rotate and swivel in various positions
- screw-on lamp base
- additional magnetic base with a magnetic disk

Technical data

Power supply:	230VAC
Electric power supply:	line connector / plug-in transformer
Lamps:	Halogen lamp 24VDC/50W
Light output:	850lm
IP rating:	IP65
Protection class:	II (plug-in transformer) III (CEE-plug-in)
Weight:	1'600g (Type 1 w/o cable) 2'200g (Type 2 w/o cable) 2'400g (Type 3 w/o cable)

Item	Designation	Lead	Plug
046273	META Type 1	1.8m	Plugtrafo 230/24V-100W
046283	META Type 2	1.8m	Plugtrafo 230/24V-100W
046299	META Type 3	1.8m	Plugtrafo 230/24V-100W
046274	META Type 1	1.8m	CEE 24V/2P
046284	META Type 2	1.8m	CEE 24V/2P
046300	META Type 3	1.8m	CEE 24V/2P

Accessories / spare parts	
046456	Screw-on magnetic foot
011595	Magnetic plate galvanised, for magnetic foot
057485	Flip switch
057487	Rubber safety cap
012119	Halogen lamp 24V/50W/GY6.35
017035	Plug-in transformer 230VAC/24VDC, 50-100W
053944	Front glass
058357	Glare protection grid, black synthetic



Lamp head with snap-switch



Lamp stand with magnetic plate and magnetic base

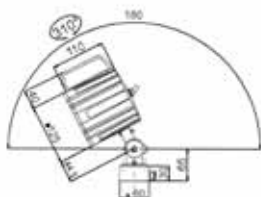

Type 1

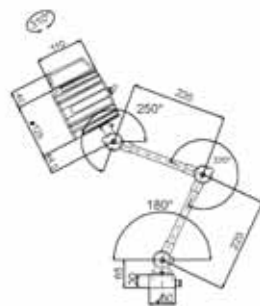

Type 2

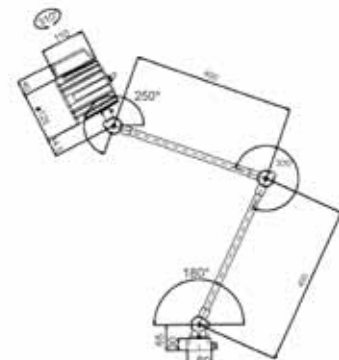

Type 3

FLAECHE workplace light



The FLAECHE workplace light has a wide beam and is therefore well-suited for precise illumination of larger workplaces such as workbenches, etc.

Product features

- wide-beam reflector
- lamp head and cover made of light grey polyamide
- flexible light holder hose, 300mm
- covered switch in the lamp head
- ballast integrated in the lamp base
- spraying water resistant design

Technical data

Power supply:	230V
Electric power supply:	Line connector
Lamps:	compact fluorescent light Dulux S
Light output:	900lm
IP rating:	IP54
Protection class:	I
Weight:	2'100g

Item	Designation	Lead	Plug
010443	230V/11W (without Magnet)	3m, 3x1.0mm ²	Type 12
050876	230V/11W (without Magnet)	3m, 3x1.0mm ²	Schuko
011556	230V/11W (without Magnet)	without	-
Accessories / spare parts			
024315	Magnetic clamp 540N, Ø86mm, black (incl. screws)		
010573	Table clamp adjustable, max. 62mm		
011595	Magnetic plate galvanised, for magnetic foot		
010572	Screw-on plate		
018405	Switch complete		
040733	Cover complete with screen		
051184	Ballast 230V/11W		
010574	Fluorescent lamp Dulux S, 11W/G23		

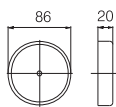

Art.-Nr. 024315

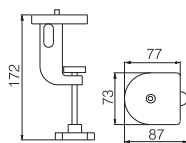

Art.-Nr. 010573

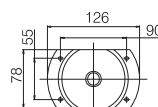

Art.-Nr. 011595

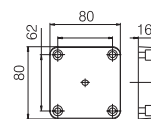

Art.-Nr. 010572

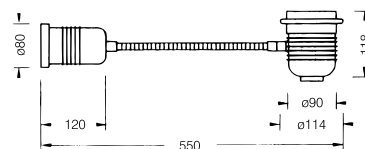
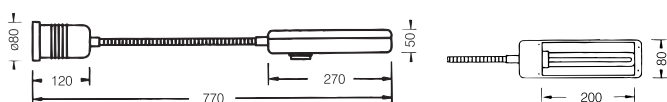

PUNKT workplace light



The PUNKT workplace light has an extremely narrow beam and makes it possible for lighting up deep hollow bodies. that is why it is used for precision work.

Product features

- high-gloss reflector
- lamp head made of silver cast aluminium
- heat-resistant edge, swivel joint, flexible light holder hose, 300mm
- Safety glass
- switch integrated in the lamp base
- transformer integrated in the lamp base, secured for 0.2A

Technical data

Power supply:	230VAC/12VDC
Electric power supply:	Line connector
Lamps:	Halogen lamp 12VDC/20W
Light output:	32lm
IP rating:	IP44
Protection class:	I
Weight:	2'100g

Item	Designation	Lead	Plug
010445	230/12V/20W (ohne Magnet)	3m, 3x1.0mm ²	Type12
050877	230/12V/20W (ohne Magnet)	3m, 3x1.0mm ²	Schuko
011557	230/12V/20W (ohne Magnet)	ohne	-
Accessories / spare parts			
024315	Magnetic clamp 540N, Ø86mm, black (incl. screws)		
010573	Table clamp adjustable, max. 62mm		
011595	Magnetic plate galvanised, for magnetic foot		
010572	Screw-on plate		
044468	Safety glass		
010575	Halogen lamp 12V/20W/G4		
056848	Switch, complete		

SpotLED LED-Spotlight



The high-performing and energy-efficient SpotLED spotlights with state-of-the-art LED-technology offer a wide range of applications for interior and exterior lighting.

The housing material (cast aluminium) can be individually combined with the other components (LED, optics, colours) and can be used for a wide variety of lighting purposes.

Whether used outdoors on transportation or work vehicles (construction, agriculture, cleaning, waste disposal, snow cats) or in the garden and on storefronts – the SpotLED puts things in the right light. There are also many applications for indoor lighting for rooms and workspaces.



Further information is available in our Product Information documents 9|1

Halogen spotlight 230V (300-1500W)



Our high-quality halogen spot lights with medium-wide beams and efficient lighting demonstrate excellent heat dissipation thanks to large cooling fins and special sockets, thus providing a long life for the halogen bulbs. They offer universal applications for short-range illumination, exterior and interior lighting for wall and ceiling mounting as well as tripod mounting with a variety of accessories.

Product features

- Housing and frame made of cast aluminium, unvarnished, with silicone seal
- all exterior steel parts are stainless
- safety glass that is resistant to changes in temperature
- linear reflector made of polished anodised aluminium
- R7s mount, galvanized steel mounting bracket (300W/500W) or made of aluminium (1000W/1500W)

Technical data

Power supply:	230VAC
Electric power supply:	Line connector
Lamps:	Halogen bulb
Light output:	300W: 5'000lm / 500W: 9'500lm 1000W: 22'000lm / 1500W: 33'000 lm
IP rating:	IP55
Protection class:	I
Weight:	1'500g (300W/500W) 3'100g (1000W) 3'600g (1500W)

Item	Designation	Lead	Plug
015760	230V/300W	5m, 3x1.0mm ²	T12
050783	230V/300W	5m, 3x1.5mm ²	Schuko
015763	230V/500W	5m, 3x1.0mm ²	T12
050779	230V/500W	5m, 3x1.5mm ²	Schuko
010529	230V/500W without burner	without	-
015767	230V/1000W	5m, 3x1.0mm ²	T12
050805	230V/1000W	5m, 3x1.5mm ²	Schuko
010531	230V/1000W without burner	ohne	-
015771	230V/1500W	5m, 3x1.0mm ²	T12
050806	230V/1500W	5m, 3x1.5mm ²	Schuko
010533	230V/1500W without burner	ohne	-

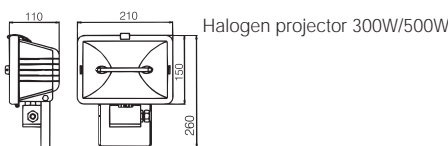

Halogen projector 300W/500W

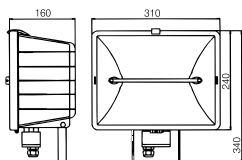

Halogen projector 1000W

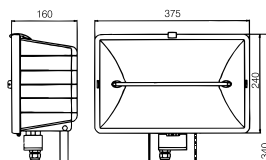

Halogen projector 1500W

Halogen spotlight 24V/42V (70-300W)



The halogen work spot light for safety low-voltage 24/42 volt is well-suited for danger zones in accordance with the relevant safety regulations. It provides even light distribution with a 24V or 42V network connection. The transformer (provided there is no low voltage network) is required separately. Excellent heat dissipation is provided by large cooling fins and special sockets, thus providing a long life for the halogen bulbs. The halogen spot light offers a wide range of applications for interior and exterior lighting for wall and ceiling mounting as well as tripod mounting with a variety of accessories.

Product features

- Housing and frame made of cast aluminium, varnished with silicone seal
- all exterior steel parts are stainless
- safety glass that is resistant to changes in temperature
- linear reflector made of polished anodised aluminium
- mounting bracket made of stainless steel

Technical data

Power supply:	24VDC/42VDC
Electric power supply:	Line connector
Lamps:	Halogen bulb
Light output:	70W: 1'200lm / 100W: 2'200lm 300W: 5'000lm
IP rating:	IP65
Protection class:	III
Weight:	1'600g

Item	Designation	Lead	Plug
050808	24V/2x70W	5m, 2x1.0mm ²	CEE 16/24V
027138	24V/2x100W	5m, 2x1.0mm ²	CEE 16/24V
050809	42V/2x70W	5m, 2x1.0mm ²	CEE 16/24V
050811	42V/2x100W	5m, 2x1.0mm ²	CEE 16/24V
010524	24/42V/300W without burner	without	-

(24 V in series connection runs also with 42/48 V)

Other cable length on request

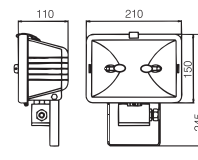

Halogen projector low voltage up to 300W

Accessories for the halogen spotlight



Various system-compatible tripods or stands can be used for mobile lighting in light-weight to particularly heavy-weight (sturdy) design. Another special feature might include two magnets screwed on to the bracket. This ensures fast and efficient mounting.

Small floor stand «Mobilight»

Well-suited for halogen spot light model 500W, tubular frame, plastic-coated with two toggle locking screws, Dimensions (LxWxH) 275x285x370mm, weight 1'300g

Big floor stand «Mobilight»

Well-suited for halogen spot light model 1000W, tubular frame, plastic-coated with two toggle locking screws, Dimensions (LxWxH) 350x370x510mm, weight 1'700g

Magnetic clamp 540N

Well-suited for all halogen spot light models. The magnets are screwed into the bracket (2 each per HLS). Dimensions \varnothing 80mm / Height 20mm

Heavy Tripod

Well-suited for all halogen spot light models, made of hot-dip galvanized steel tubing, telescoping from 1.5–3.5m height, can be locked in place with two adjustable locking toggles, adjustable base plates for additional anchoring on uneven terrain, weight 16.4kg, collapsible to 1'630x200x140mm, with additional pins, also well-suited for search and work spot lighting.

Standard Tripod

Well-suited for all halogen spot light models, made of galvanized steel, yellow chrome, telescoping from 1.0–3.5m height with telescopic tubing (protected against slippage), retracted length 1.05m, adjustable base plates with a hole for additional anchoring, only for even terrain, weight is 7'300 g, collapsible to 1,070x130x120mm, with additional pins, also well-suited for search and work spot lighting.

Item	Accessories	Design*
010587	MobiLIGHT base frame small	1 - 4
010588	MobiLIGHT base frame large	2, 3
024315	Magnetic clamp 540N, \varnothing 86mm, black	1 - 4
010585	Light tripod heavy-weight 1.5–3.5m (also for uneven ground)	1 - 4
010586	Light tripod standard 1.0–3.5m (also for uneven ground)	1 - 4
016228	Halogen bulb 230V/300W/R7s	1
010555	Halogen bulb 230V/400W/R7s	1
010556	Halogen bulb 240V/1000W/R7s	2
010557	Halogen bulb 240V/1500W/R7s	3
010539	Halogen bulb 24V/70W/GY6.35 (2 pieces)	4
010538	Halogen bulb 24V/100W/GY6.35 (2 pieces)	4
027464	Protective grid stainless steel for type 500W	1, 4
027463	Protective grid stainless steel for type 1000W	2
027462	Protective grid stainless steel for type 1500W	3
010599	Slat baffle, stainless steel for type 500W	1, 4



Item	Accessories	Design*
010609	Slat baffle, stainless steel for type 1000W	2
010615	Slat baffle, stainless steel for type 1500W	3
040718	Three-sided baffle, stainless steel for type 500W	1, 4
040719	Three-sided baffle, stainless steel for type 1000W	2
040720	Three-sided baffle, stainless steel for type 1500W	3
Spare parts		
010591	Hard glass window for type 500W	1, 4
010602	Hard glass window for type 1000W	2
010610	Hard glass window for type 1500W	3
010601	Lamp socket R7s for type 500W	1
010608	Lamp socket R7s for type 1000W	2, 3
010598	Lamp socket GY6 35 for type 300W	4
010592	Frame for type 500W	1, 4
010603	Frame for type 1000W	2
010611	Frame for type 1500W	3
011843	Reflector, shiny anodised for type 500W	1, 4
010607	Reflector, shiny anodised for type 1000W	2
010614	Reflector, shiny anodised for type 1500W	3
010593	Gasket silicone for type 500W	1, 4
010604	Gasket silicone for type 1000W	2
010612	Gasket silicone for type 1500W	3
040731	Assembly bracket, stainless steel for type 500W	1, 4
040732	Assembly bracket, galvanised steel for type 500W	1
040730	Assembly bracket, aluminium for type 1000W, 1500W	2, 3
010595	Connection casing complete for type 500W	1, 4
010606	Connection casing complete for type 1000W	2
010613	Connection casing complete for type 1500W	3
010600	Locking device Inox	1 - 4

* Designation:

1 = 230V/300–500W

2 = 230V/1000W

3 = 230V/1500W

4 = 24V/42V/70–300W

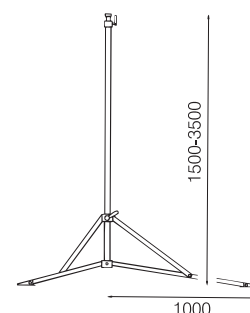
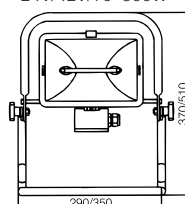

SYLVEO Floodlight



The high-quality, wide beam SYLVEO flood lights were developed for the extensive and versatile use both indoors and outdoors. The reflectors are high gloss polished and made of anodised aluminium with a hammer tone look. With a special design to optimise the output of light.

Product features

- Sturdy, corrosion-protected LM6 cast aluminium housing (3mm) with cooling fins
- Metallic grey polyester coating (RAL 9006)
- Operating temperature from -30°C to +40°C
- Bulbs and wiring compartment are isolated
- Enclosure: IP65 (silicon seal)
- Direct front access to bulb and junction box
- The 5 mm tinted glass is mounted on the bottom with two adjustable captive brackets. The glass is secured on the top side by two removable brackets.
- The bracket for the glass is made of aluminium
- All external screws are made of stainless steel.
- The reflectors are high gloss polished and made of anodised aluminium
- (99.8%). Symmetric wide beam with a hammer tone look. With a special design to optimise the output of light.
- Galvanised mounting bracket (M10)
- Can be mounted to the ceiling, floor or walls
- Supply line connection is easy and direct

Technical data

Power supply:	230VAC
Electric power supply:	Line connector
Lamps:	metal halide lamp
IP rating:	IP65
Protection class:	I
Dimension (HxWxD):	402x348x133mm
Weight:	8'200g

Item	Designation	Designation
101793	SYLVEO floodlight 150W incl. metal halide lamp, RXs-24, spread beam	150W/ RX7S-24
101794	SYLVEO floodlight 400W incl. metal halide lamp, E40, spread beam	400W/E40
Accessories / spare parts		
101820	Metal halide lamp	150W RX7S-24
101821	Metal halide lamp	400W E40

Applications



Halogen Spot Light



Halogen Spot Light



SpotLED

Fluorescent Bulbs



Fluorescent bulbs are extremely effective. They remain relatively cool during operation and save energy. They are the most economical option whenever homogenous surface light of average power is required. We use them mostly in the area of tubular lamps and torches for close range applications. Fluorescent bulbs last up to 8 to 10 times longer than standard commercial bulbs. Based on their extremely high degree of efficiency they save up to 80% of the cost of power.

Fluorescent lamp						
Item	Designation	Socket	Output	Length	Light output	Light colour
040704	Dulux S/E	2G7	9W	144mm	600lm	840
040737	Dulux S/E	2G7	11W	214mm	900lm	840
010574	Dulux S	G23	11W	214mm	900lm	840
040090	Dulux L	2G11	18W	217mm	1'200lm	840
051713	Dulux L	2G11	24W	317mm	1'800lm	840
040092	Dulux L	2G11	36W	411mm	2'900lm	840
040510	Dulux L	2G11	40W	533mm	3'500lm	840
052064	Dulux L	2G11	55W	533mm	4'800lm	840
033073	Dulux L	2G11	80W	570mm	6'150lm	840
048126	Dulux F	2G10	36W	217mm	2'800lm	840
020204	T5	G5	39W	849mm	3'100lm	840
020205	T5	G5	54W	1'149mm	4'450lm	840
020206	T5	G5	80W	1'149mm	6'150lm	840
052065	T8	G13	18W	590mm	1'350lm	840
010467	T8	G13	36W	1'200mm	2'850lm	640
050911	T8	G13	36W	1'200mm	3'350lm	840
050657	T8	G13	58W	1'500mm	4'100lm	640
051312	T8	G13	58W	1'500mm	5'000lm	840
052509	2D	GRY10q-4	38W	Spez.	2'850lm	835
041807	2D	GRY10q-4	55W	Spez.	3'900lm	835
041027	PLEC	E27	16W	145mm	930lm	830
105344	PLC	G24q2	18W	146mm	1'140lm	865
Metal halide lamp						
Item	Designation	Socket	Output	Voltage	Light output	Light colour
101820	150W	RX7s-24	150W	95V	12'500lm	4200K
101821	400W	E40	400W	130V	36'000lm	4200K



Standard fluorescent tube



PLEC energy-saving lamp



Fluorescent lamp

Halogen Bulbs



The Gifas halogen bulbs are very impressive in their practical application. The longer burning time results from the improved design on the inside. You can use these reinforced models anywhere. This is really important for mobile applications. The halogen spot lights have proven to be particularly excellent. The optimised reflectors and high-quality construction guarantee the best efficiency and long operating life.

Halogen bulbs						
Item	Output	Voltage	Socket	Length	Light output	Light colour
035242	20W	12V	GY 6.35	44mm	340lm	2800K
010575	20W	12V	G4	33mm	300lm	2800K
013219	50W	12V	GY 6.35	44mm	910lm	3000K
035843	30W	6V	G4	31mm	765lm	3350K
013851	20W	24V	G4	33mm	320lm	3000K
012119	50W	24V	GY 6.35	44mm	900lm	3000K
010539	70W	24V	GY 6.35	44mm	1'200lm	3000K
010538	100W	24V	GY 6.35	44mm	2'200lm	3000K
059039	20W	24V	Ba15d	28mm	350lm	
050948	50W	24V	Ba15d	43mm	850lm	
050949	50W	42V	Ba15d	54mm	500lm	
058213	50W	36-42V	GY 6,35	44mm	850lm	
Halogen bulbs						
Item	Output	Voltage	Socket	Length	Light output	Light colour
016228	300W	230V	R7s	119.6mm	5'000lm	3000K
010555	400W	230V	R7s	119.6mm	9'000lm	3000K
010556	1000W	240V	R7s	189.1mm	21'000lm	3000K
010557	1500W	240V	R7s	254.1mm	32'000lm	3000K
010558	2000W	240V	R7s	331.0mm	44'000lm	3000K
Halogen projectors						
Item	Output	Voltage	Socket	Angle	Light output	Light colour
010543	60W	12V	G53	12°/5°	25'000cd	
010544	100W	13V	G53	12°/6°	24'650cd	
010546	50W	28V	G53	12°/5°	45'000cd	
010545	100W	28V	G53	13°/7°	70'000cd	



Double-ended halogen lamp



Halogen bulb



Halogen projector

Applications



SpotLED



SpotLED



ToppLED



FlatLED



MarkLED



SecuLED

Applications



SpotLED



CircLED



VisuLED



VisuLED



ToppLED



ToppLED

Applications



GT safety tubular light



MULTI Working lamp



GT safety tubular light



PRIMA Flood light



GT safety tubular light



FlatLED



MarkLED

The MarkLED is a cable-guiding system with current carried through direct connections. This allows us to reach a very high efficiency factor (> 80%) and to remain within the limits for electromagnetic compatibility (EMC). By using state-of-the-art LED technology, power consumption is now only 40 mA per unit with increased light intensity. Thus we can lay cables with approx. 60 modules max. Thanks to the high energy efficiency, the power consumption is extremely low, which greatly contributes to keeping operating costs low. Based on these technical facts, we are able to meet the regulations set forth by the German Federal Highway Research Institute (BAST-Deutschland - Bundesanstalt für Strassenwesen) which also apply to us and other countries.



FlatLED

Ever since optical guiding devices have become a topic of discussion, flat systems that can be driven over have also been part of the discussion. Over the past few years, this need has become clearer and several products were developed for the market. GIFAS also accepted the challenge and completely revised the prototype of the FlatLED. The new generation of the FlatLED now meets all of the more recent guidelines (BAST, etc.) and is also a state-of-the-art device.



SecuLED

In contrast to the looped transmission of electrical current as is used for the MarkLED system, the SecuLED series of products uses the conventional wired system. The modules can be directly cabled and looped. The two-part construction in particular makes maintenance and repair much easier.



Further information is available in our brochure optical guidance systems 9a.



VisuLED

The recessed luminaire with the state-of-the-art light technology and modern chrome steel design. Is designed to be built into walls, ceilings or floors, for example as central building control system and/or as decorative accent lighting in entrance halls, parking lots and all kinds of spaces. Additional applications include lighting paths and areas in underground garages, houses and gardens. They are available in a variety of frames, equipped with Power-LED @ 2, 4 Watt in various colours, angles of beam and with clear or matte glass inserts – they are individual just like their area of application!



CircLED

The recessed luminaire with special lighting in a special plastic housing. As it is preferably built in as a floor or wall light, the CircLED is used for specific applications. The main focus is on lighting round-about traffic where it is used as a safety, guidance and design light. Besides its many other applications, when it is used for lighting pathways (mounted in the ground or in walls), the CircLED creates a nearly mystical radiation pattern on the ground and the wall, in addition to its main function. It is available with various tops, integrated light optics and various lighting colours – all in accordance with your wishes and requirements!



ToppLED

The most "playful" if all recessed lights. Developed from the MarkLED that has been used a thousand times, we have created a product that above all is able to meet aesthetic demands. The ToppLED is used for design applications in homes and gardens, even in swimming pools and basins and has already been used as "decorative elements" for piers. It is available in different lighting colours – whatever matches your idea the best!



Further information is available in our Product Information documents 9|2, 9|3 and 9|4.

You will find some specific informations's about our innovations and special solutions as well as the latest catalouge on our website:

www.gifas.ch

